

## 24th Annual Chili Pepper Classic Women's 40-50 Division

		WON	LOST	RUNS ALLOWED
1	COMIN' IN ICY HOT (40 AAA)	11		
2	Lady OG's 40 (AA)	1	1	
3	3 Up, 3 Down (50 AAA)	1	1	
4	Get Dirty (50 AAA)	1	1	
5	Lady OG's 50 (AAA)		11	
6	Wicked (50 AAA)	1	1	

SATURDAY, March 29 \* El Paso Sports Complex \* (1780 N. Zaragoza Rd)

TIME	TEAM	NAME	FIELD	TEAM	NAME
8:00	1	19 COMIN IN HOT	5	3	16 \$ 3 Up, 3 Down
8:00	2	9 Lady OG's 40	6	4	22 Get Dirty 50
9:30	3	20 3 Up, 3 Down	5	5	7 Lady OG's 50
9:30	4	15 Get Dirty 50	6	6	16 Wicked 50
11:00	5	9 \$ Lady OG's 50	5	1	24 COMIN IN HOT
11:00	6	8 Wicked	6	2	15 Lady OG's 40

**Format:** 4gg: 2 RR games with Teams 1-2 and 3-6 advancing to separate DE brackets.

**Bats:** Bats must have the SSUSA /NTS logo, or say Senior Softball Approved

**Balls:** Each team will receive 6 Baden Fire balls (red stitch, synthetic cover) at check in.

>>> Only the red stitch / synthetic cover ball can be used.

**Home Team:** Determined by a coin flip in all games that do not involve an equalizer.

**Championship Game:** If no equalizer, the unbeaten team has the choice of home or visitor.

**Equalizer \$** - Team 1 GIVES an equalizer (5 runs or 11 defenders) and is HOME in all games

**Home Runs-** AAA = 3 per team, per game. AA = 1 per team, per game.

**Pitch Count:** Batter begins with a 1-1 count and does get a courtesy foul.

**Runs per Inning-** 5 runs per ½ inning at bat (except open inning)

**Time Limits-** Seed games = 65 minutes + open. Bracket = 70 minutes. Champ = 80 mins.

**Seeding-** 1) Overall Record 2) Head to Head in full RR only 3) Runs Allowed 4) Differential

**Awards-** One Awards set to the winner of the each bracket.

**Schedule is Subject to Change at Discretion of Tournament and Field Directors**

**SSUSA CHILI PEPPER CLASSIC**  
**Women's 40 Silver Division- 2 Teams**  
 ALL GAMES @ El Paso County Sports Complex

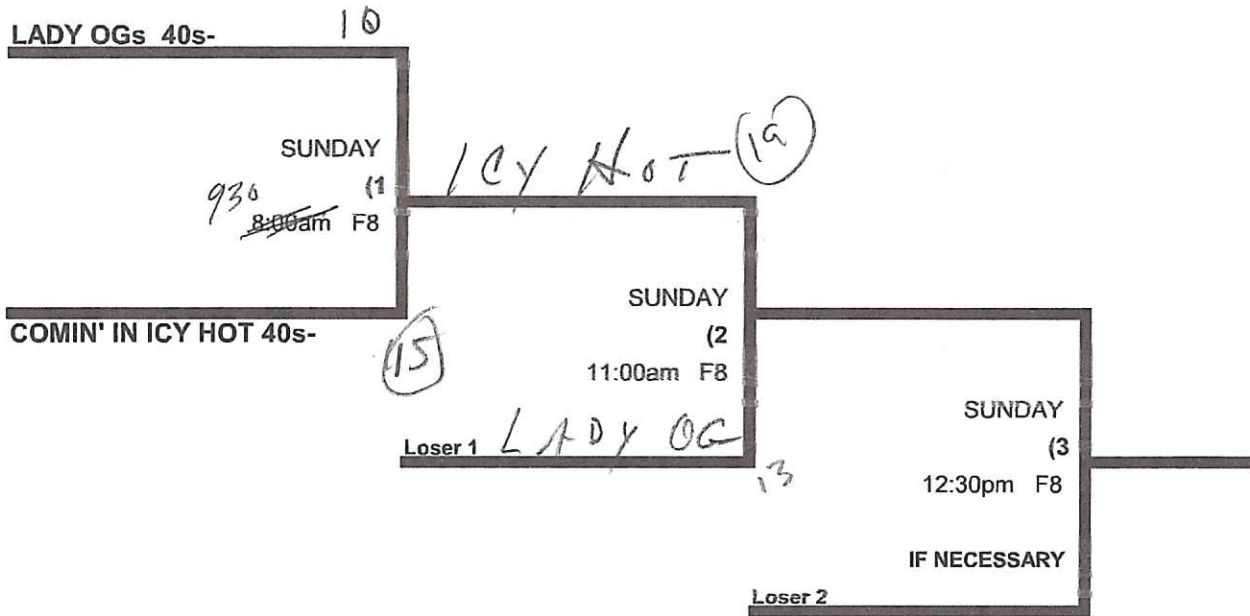

LADY OG's (40 AA) RECEIVES an equalizer, and is VISITOR in all games during the bracket.

# SSUSA CHILI PEPPER CLASSIC

Women's 50 AAA Division- 4 Teams

ALL GAMES @ El Paso County Sports Complex

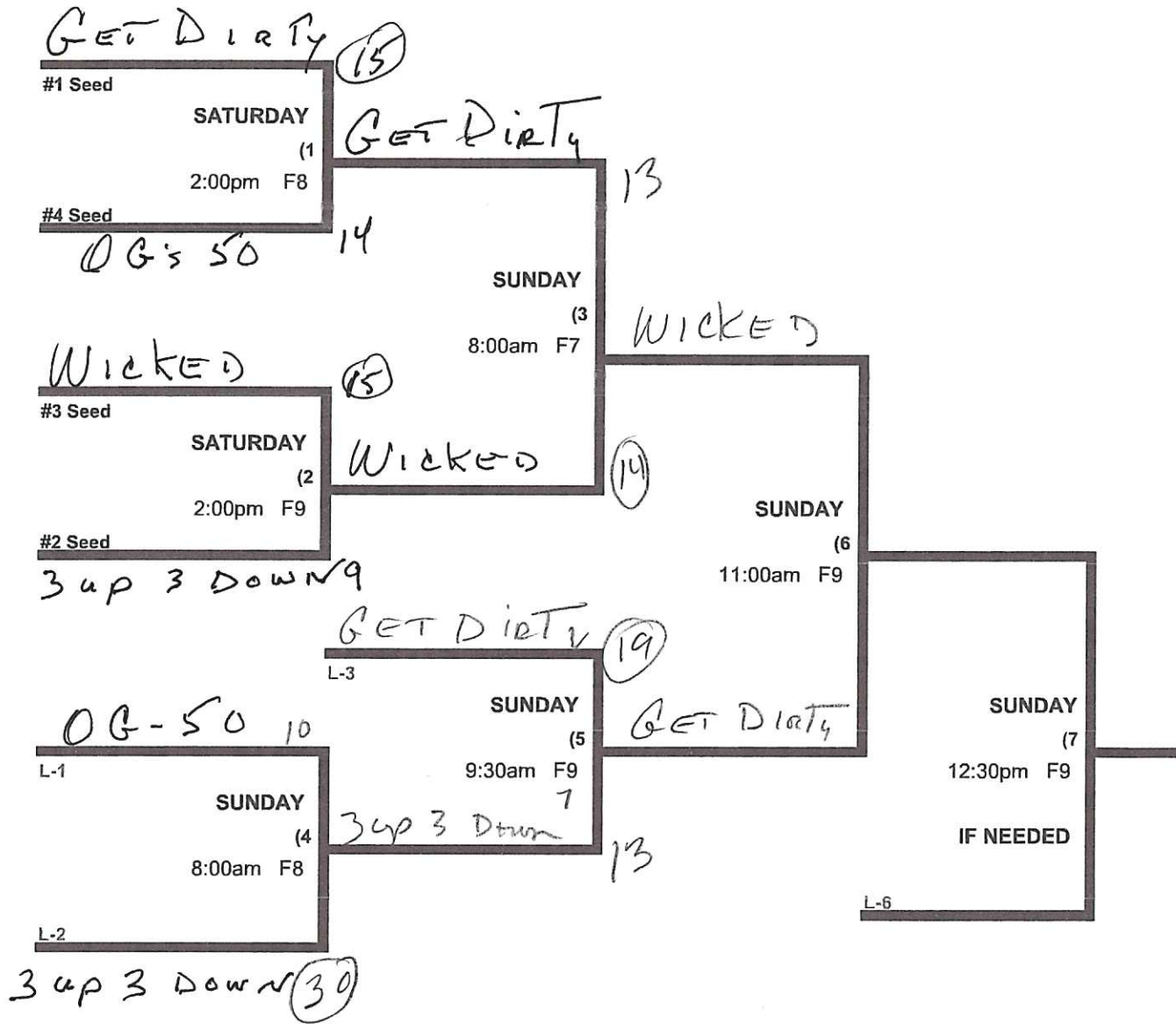



## 24th Annual Chili Pepper Classic Men's 40 Gold Division

		WON	LOST	RUNS ALLOWED
1	Chuco Town / A's (Major)	/	/	
2	Duke City 40s (Major)	/	/	
3	EPT 40s (Major)	//		
4	Forty Cal / NM Elite (Major)	/	/	
5	Latinos (Major)		//	
6	Ohana Over Everything (Major)		//	
7	That's Old Folks (Major)	/	/	
8	Astros 40s (AAA)	//		

SATURDAY, March 29 \* Northeast Regional Park \* (11270 McCombs St- El Paso, TX)

TIME	TEAM	NAME	FIELD	TEAM	NAME
11:00	1	<u>25</u> Chuco Town / A's	1	5	<u>17</u> Latinos
11:00	2	<u>11</u> Duke City 40s	2	6	<u>20</u> Ohana Over Every
11:00	3	<u>25</u> EPT 40s	3	7	<u>23</u> That's Old Folks
11:00	4	<u>28</u> Forty Cal / NM Elite	4	8	<u>29</u> \$ Astros 40s
12:30	7	<u>20</u> That's Old Folks	1	5	<u>12</u> Latinos
12:30	6	<u>13</u> Ohana Over Every	2	4	<u>21</u> Forty Cal / NM Elite
12:30	3	<u>22</u> EPT 40s	3	1	<u>18</u> Chuco Town / A's
12:30	8	<u>33</u> \$ Astros 40s	4	2	<u>24</u> Duke City 40s

**Format:** 4gg: 2 RR games with all teams advancing to a double elimination bracket.

**Bats:** Bats must have the SSUSA /NTS logo, or say Senior Softball Approved

**Balls:** Each team will receive 6 Baden Fire balls (red stitch, synthetic cover) at check in.

>>> Only the red stitch / synthetic cover ball can be used.

**Home Team:** Determined by a coin flip in all games that do not involve an equalizer.

**Championship Game:** If no equalizer, the unbeaten team has the choice of home or visitor.

**Equalizer \$** - Team 7 RECEIVES a 5-run equalizer and is VISITOR in all games.

**Home Runs-** 40 Major vs 40 Major = 8 HR. All other games = 6 HR.

**Pitch Count:** Batter begins with a 1-1 count and does get a courtesy foul.

**Runs per Inning-** 5 runs per ½ inning at bat (except open inning)

**Time Limits-** Seed games = 65 minutes + open. Bracket = 70 minutes. Champ = 80 mins.

**Seeding-** 1) Overall Record 2) Head to Head in full RR only 3) Runs Allowed 4) Differential

**Awards-** One Awards set to the winner of the each bracket.

**Schedule is Subject to Change at Discretion of Tournament and Field Directors**

# SSUSA CHILI PEPPER CLASSIC

Men's 40 Gold Division- 8 Teams

SAT GAMES @ Northeast Regional Park. SUN GAMES @ The El Paso Sportspark.

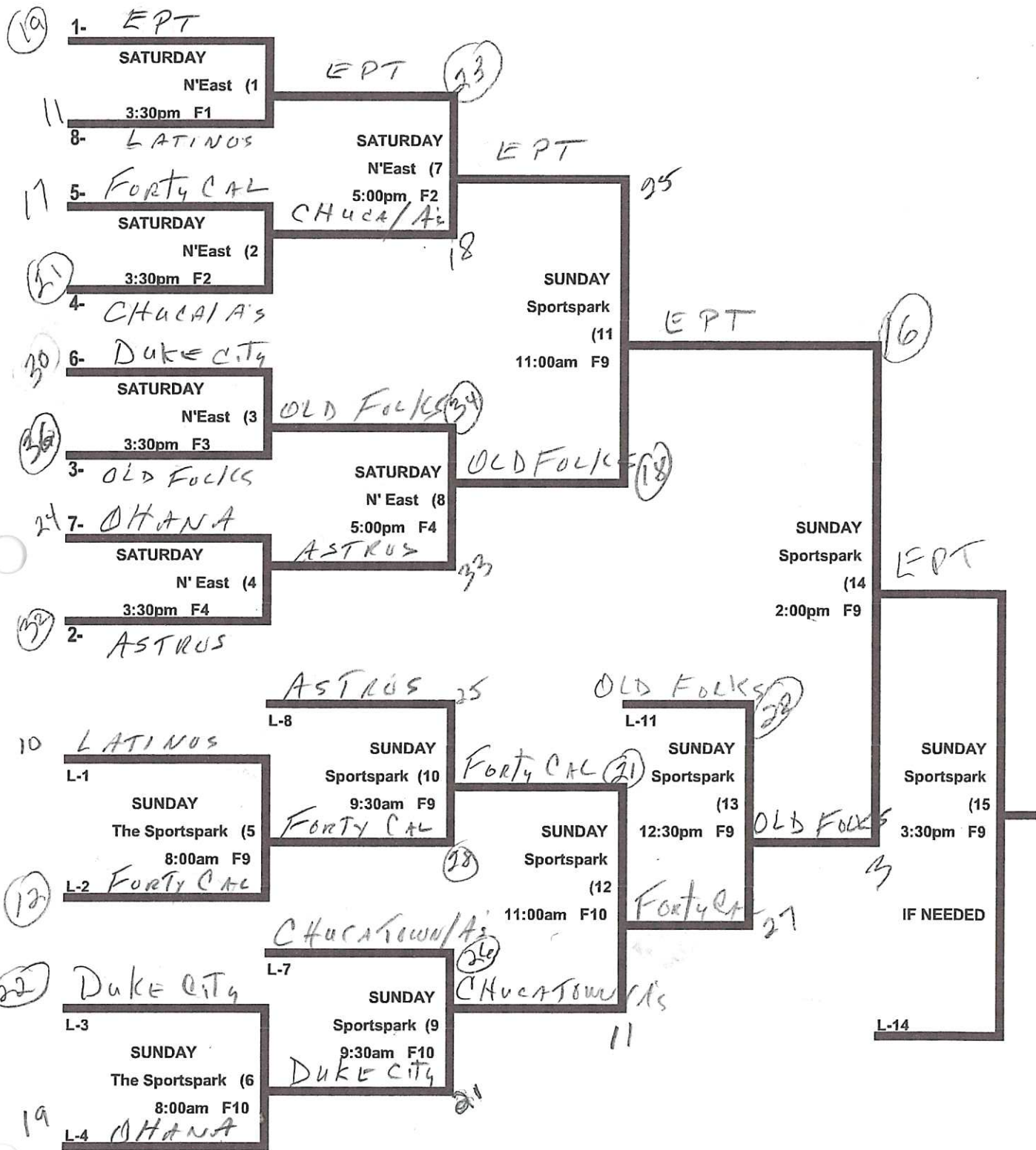



## 24th Annual Chili Pepper Classic Men's 50 Gold Division

		WON	LOST	RUNS ALLOWED
1	New Mexico Silver Backs (Major)	11		
2	Tucson Hammertime (Major)	1	1	
3	Astros 50s (AAA)		11	
4	Duke City 50s (AAA)	1	1	
5	El Paso Angels 50 (AAA)	11		
6	El Paso Strong 50 (AAA)	11		
7	El Paso Toros (AAA)		11	
8	Misfits 50 (AAA)		11	

SATURDAY, March 29 \* Northeast Regional Park \* (11270 McCombs St- El Paso, TX)

TIME	TEAM	NAME	FIELD	TEAM	NAME
8:00	1	<u>24</u> N.M. Silver Backs	1	7	<u>23</u> \$ El Paso Toros
8:00	2	<u>5</u> Tucson H'Time	2	6	<u>28</u> \$ El Paso Strong
8:00	3	<u>13</u> Astros 50s	3	5	<u>20</u> El Paso Angels
8:00	4	<u>13</u> Duke City 50s	4	8	<u>7</u> Misfits 50
9:30	7	<u>10</u> El Paso Toros	1	5	<u>15</u> El Paso Angels
9:30	6	<u>14</u> El Paso Strong	2	8	<u>13</u> Misfits 50
9:30	3	<u>29</u> \$ Astros 50s	3	1	<u>30</u> N.M. Silver Backs
9:30	4	<u>25</u> \$ Duke City 50s	4	2	<u>24</u> Tucson H'Time

**Format:** 4gg: 2 RR games with all teams advancing to a double elimination bracket.

**Bats:** Bats must have the SSUSA /NTS logo, or say Senior Softball Approved

**Balls:** Each team will receive 6 Baden Fire balls (red stitch, synthetic cover) at check in.

>>> Only the red stitch / synthetic cover ball can be used.

**Home Team:** Determined by a coin flip in all games that do not involve an equalizer.

**Championship Game:** If no equalizer, the unbeaten team has the choice of home or visitor.

**Equalizer \$** - Teams 1-2 GIVE an equalizer (5 runs or 11 defenders) and is HOME in all games.

**Home Runs-** Major vs Major = 6 HR. All other games = 3 HR.

**Pitch Count:** Batter begins with a 1-1 count and does get a courtesy foul.

**Runs per Inning-** 5 runs per ½ inning at bat (except open inning)

**Time Limits-** Seed games = 65 minutes + open. Bracket = 70 minutes. Champ = 80 mins.

**Seeding-** 1) Overall Record 2) Head to Head in full RR only 3) Runs Allowed 4) Differential

**Awards-** One Awards set to the winner of the each bracket.

**Schedule is Subject to Change at Discretion of Tournament and Field Directors**

# SSUSA CHILI PEPPER CLASSIC

Men's 50 Gold Division- 8 Teams

SAT GAMES @ Northeast Regional Park. SUN GAMES @ The El Paso Sportspark.

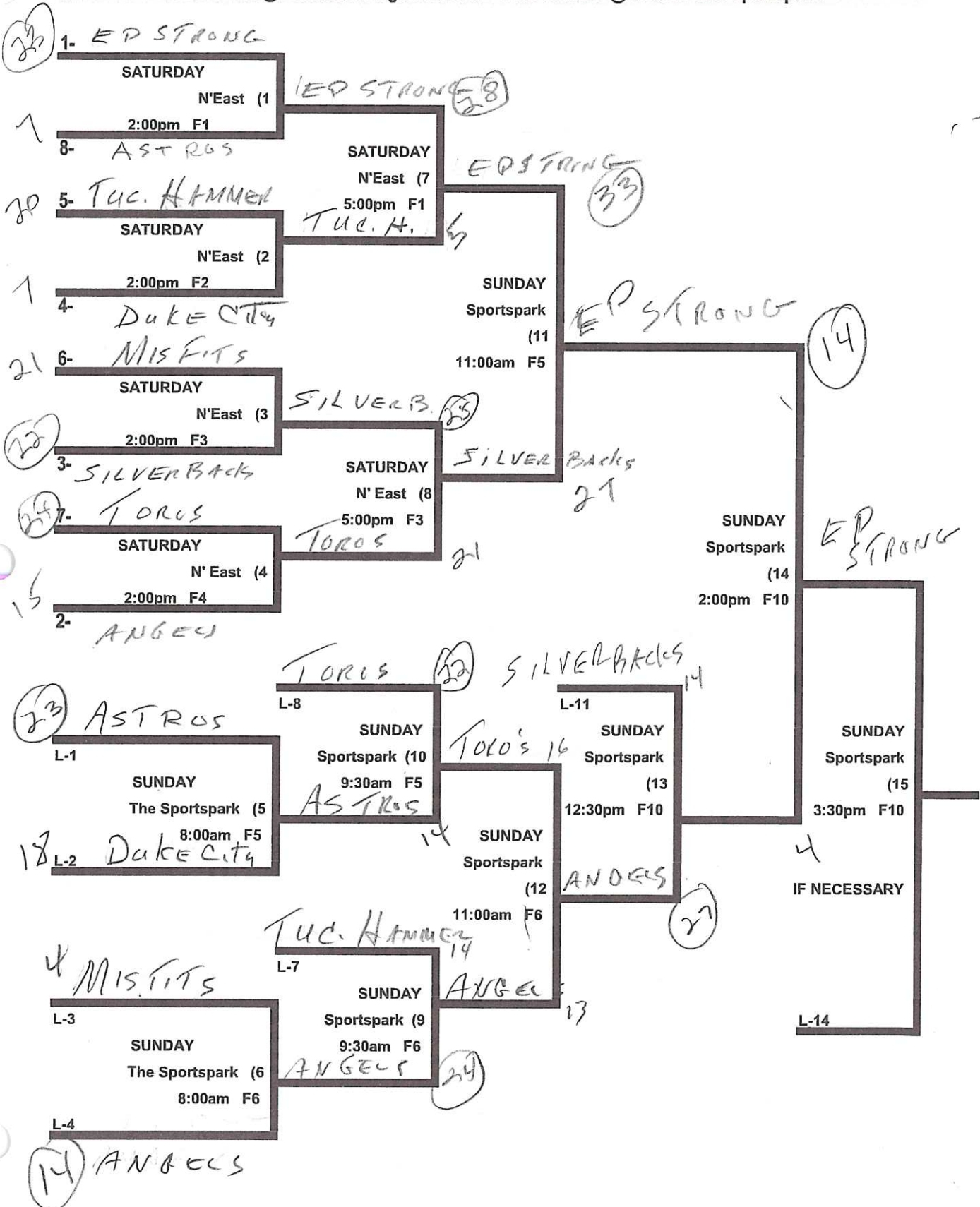



## 24th Annual Chili Pepper Classic Men's 55 Gold Division

		WON	LOST	RUNS ALLOWED
1	Originals 55 (Major)			
2	Duke City Empire (55 AAA)			
3	Los Amigos (55 AAA)			
4	Paly (55 AAA)			
5	Sunkings 55 (AAA)			
6	Team Trucha (55 AAA)			
7	Team Vega (55 AAA)			

FRIDAY, March 28 \* El Paso Sports Complex \* (1780 N. Zaragoza Rd - El Paso, TX)

TIME	TEAM	NAME	FIELD	TEAM	NAME
9:00	1	Originals 55	7	7	\$ Team Vega
9:00	2	Duke City Empire	8	6	Team Trucha
9:00	3	Los Amigos	9	5	Sunkings 55
10:30	7	Team Vega	7	4	Paly
10:30	6	Team Trucha	8	3	Los Amigos
12:00	4	\$ Paly	7	1	Originals 55
12:00	5	Sunkings 55	8	2	Duke City Empire

**Format:** 4gg: 2 RR games with all teams advancing to a double elimination bracket.

**Bats:** Bats must have the SSUSA /NTS logo, or say Senior Softball Approved

**Balls:** Each team will receive 6 Baden Fire balls (red stitch, synthetic cover) at check in.

>>> Only the red stitch / synthetic cover ball can be used.

**Home Team:** Determined by a coin flip in all games that do not involve an equalizer.

**Championship Game:** If no equalizer, the unbeaten team has the choice of home or visitor.

**Equalizer \$** - Team 1 GIVES an equalizer (5 runs or 11 defenders) and is HOME in all games.

**Home Runs-** AAA = 3 per team, per game.

**Pitch Count:** Batter begins with a 1-1 count and does get a courtesy foul.

**Runs per Inning-** 5 runs per ½ inning at bat (except open inning)

**Time Limits-** Seed games = 65 minutes + open. Bracket = 70 minutes. Champ = 80 mins.

**Seeding-** 1) Overall Record 2) Head to Head in full RR only 3) Runs Allowed 4) Differential

**Awards-** One Awards set to the winner of the each bracket.

**Schedule is Subject to Change at Discretion of Tournament and Field Directors**



# SSUSA CHILI PEPPER CLASSIC

Men's 55 Gold Division- 7 Teams

ALL GAMES @ El Paso County Sports Complex

Duke City

#1

FRIDAY

500

(4)

4:30pm F9

VEGA

10

VEGA

8

(13)

VEGA

#5

FRIDAY (1)

200

1:30pm F9

#4

SUN KINGS

3 LOS AMIGOS

#3

FRIDAY (2)

200

1:30pm F10

#6

TRUCHA

SATURDAY

(9)

12:30pm F7

PALY

23

(16)

TRUCHA

FRIDAY

(5)

500

4:30pm F10

PALY

(25)

(22)

PALY

#7

FRIDAY (3)

330

3:00pm F10

#2

ORIGINALS

SATURDAY

(12)

3:30pm F7

20

19

Duke City

L-4

SATURDAY

(8)

9:30am F7

ORIGINALS

VEGA

L-9

SATURDAY

(11)

2:00pm F7

VEGA

SATURDAY

(13)

5:00pm F7

VEGA

17 LOS AMIGOS

L-2

SATURDAY

(6)

8:00am F7

ORIGINALS

SATURDAY

(10)

11:00am F7

ORIG.

VEGA

IF GAME

(18)

ORIGINALS

SUN KINGS

L-1

SATURDAY

(7)

9:30am F8

SUN KINGS

L-5

TRUCHA

13

L-12

(21)

## 24th Annual Chili Pepper Classic Men's 60 Gold Division

		WON	LOST	RUNS ALLOWED
1	Tejanos (60 Major)			
2	NM Desperados (60 AAA)			
3	Tucson Hammertime (60 AAA)			
4	TX-NM Spurs (60 AAA)			

FRIDAY, March 28 \* El Paso Sports Complex \* (1780 N. Zaragoza Rd - El Paso, TX)

TIME	TEAM	NAME	FIELD	TEAM	NAME
1:30	1	<u>21</u> Tejanos	7	3	<u>19</u> \$ Tucson H'time
1:30	2	<u>22</u> NM Desperados	8	4	<u>15</u> TX-NM Spurs
3:00	3	<u>25</u> Tucson H'time	7	2	<u>29</u> NM Desperados
3:00	4	<u>14</u> \$ TX-NM Spurs	8	1	<u>21</u> Tejanos

**Format:** 4gg: 2 RR games with all teams advancing to a double elimination bracket.

**Bats:** Bats must have the SSUSA /NTS logo, or say Senior Softball Approved

**Balls:** Each team will receive 6 Baden Fire balls (red stitch, synthetic cover) at check in.

>>> Only the red stitch / synthetic cover ball can be used.

**Home Team:** Determined by a coin flip in all games that do not involve an equalizer.

**Championship Game:** If no equalizer, the unbeaten team has the choice of home or visitor.

**Equalizer \$** - Team 1 GIVES an equalizer (5 runs or 11 defenders) and is HOME in all games.

**Home Runs-** AAA = 3 per team, per game.

**Pitch Count:** Batter begins with a 1-1 count and does get a courtesy foul.

**Runs per Inning-** 5 runs per ½ inning at bat (except open inning)

**Time Limits-** Seed games = 65 minutes + open. Bracket = 70 minutes. Champ = 80 mins.

**Seeding-** 1) Overall Record 2) Head to Head in full RR only 3) Runs Allowed 4) Differential

**Awards-** One Awards set to the winner of the each bracket.

**Schedule is Subject to Change at Discretion of Tournament and Field Directors**

**SSUSA CHILI PEPPER CLASSIC**  
**Men's 60 Gold Division- 4 Teams**  
 ALL GAMES @ El Paso County Sports Complex

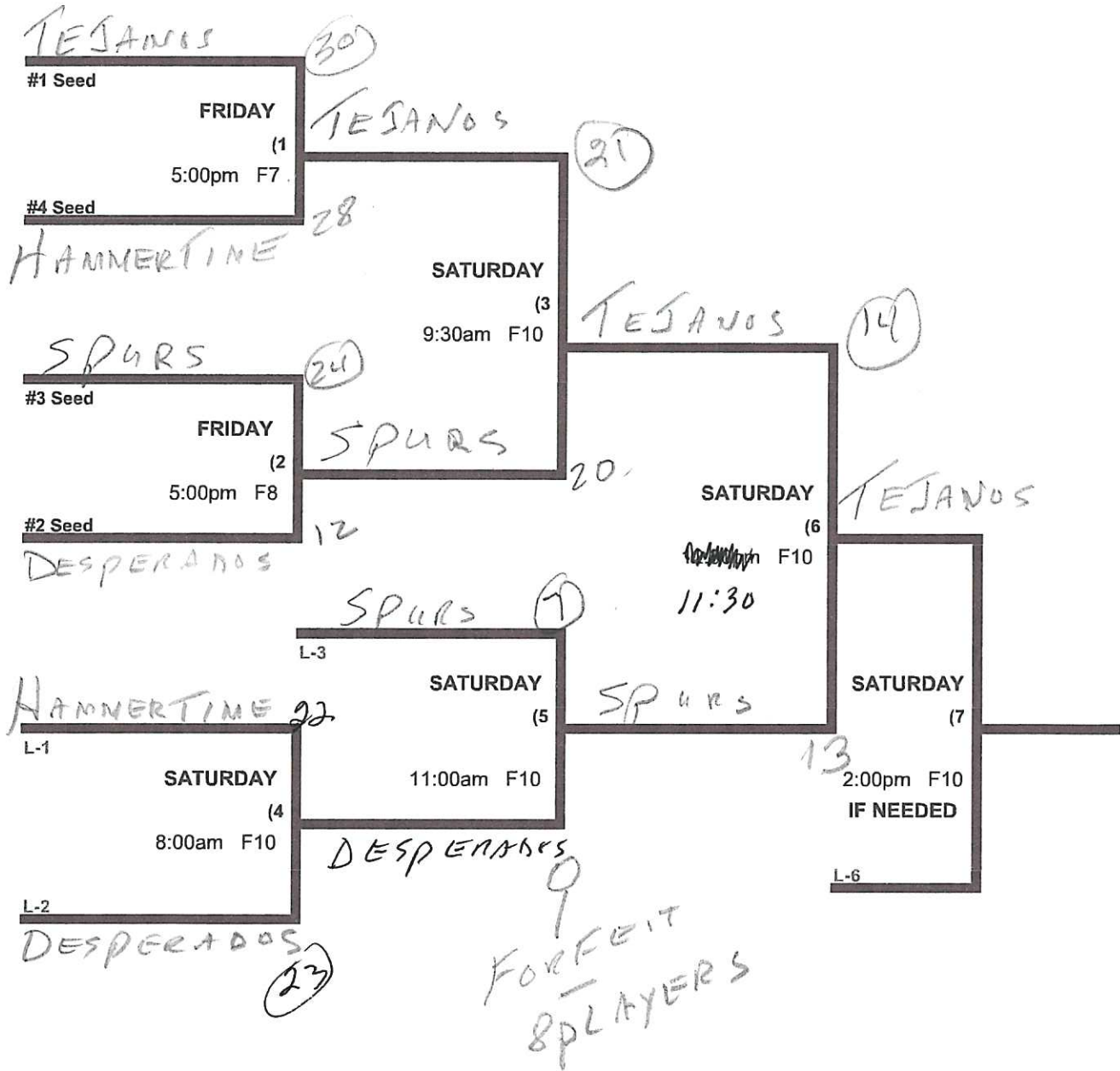



## 24th Annual Chili Pepper Classic Men's 60-65-70 Division

		WON	LOST	RUNS ALLOWED
1	El Paso Bad Boys (60 AA)	/	/	
2	Albuquerque Asphalt (65 AAA)	//		
3	El Paso Old School (65 AAA)	/	/	
4	Drillers (70 AAA)	/	/	
5	New Mexico Boomers (70 AAA)	/	/	

FRIDAY, March 28 \* El Paso Sports Complex \* (1780 N. Zaragoza Rd - El Paso, TX)

TIME	TEAM	NAME	FIELD	TEAM	NAME
9:00	2	<u>27</u> ABQ Asphalt	10	3	<u>17</u> El Paso Old School
10:30	1	<u>3</u> El Paso Bad Boys	9	4	<u>16</u> Drillers 70
10:30	3	<u>17</u> El Paso Old School	10	5	<u>9</u> \$ N.M. Boomers
12:00	5	<u>6</u> \$ N.M. Boomers	9	1	<u>14</u> El Paso Bad Boys
12:00	4	<u>11</u> \$ Drillers 70	10	2	<u>24</u> ABQ Asphalt

**Format:** 4gg: 2 RR games with Teams 1-3 and 4-5 advancing to double elimination brackets.

**Bats:** Bats must have the SSUSA /NTS logo, or say Senior Softball Approved

**Balls:** Each team will receive 6 Baden Fire balls (red stitch, synthetic cover) at check in.

>>> Only the red stitch / synthetic cover ball can be used.

**Home Team:** Determined by a coin flip in all games that do not involve an equalizer.

**Championship Game:** If no equalizer, the unbeaten team has the choice of home or visitor.

**Equalizer \$** - Teams 1-3 GIVE an 5 run equalizer to Teams 4-5 in all games.

**Home Runs-** AAA = 3 per team, per game. AA = 1 . Play to lower rated HR total in all games.

**Pitch Count:** Batter begins with a 1-1 count and does get a courtesy foul.

**Runs per Inning-** 5 runs per ½ inning at bat (except open inning)

**Time Limits-** Seed games = 65 minutes + open. Bracket = 70 minutes. Champ = 80 mins.

**Seeding-** 1) Overall Record 2) Head to Head in full RR only 3) Runs Allowed 4) Differential

**Awards-** One Awards set to the winner of the each bracket.

**Schedule is Subject to Change at Discretion of Tournament and Field Directors**

**SSUSA CHILI PEPPER CLASSIC**  
**Men's 60-65 Silver Division- 3 Teams**  
 ALL GAMES @ El Paso County Sports Complex



**NOTE: Winner of Game 2 has the choice of Home / Visitor in the Championship Game**

**SSUSA CHILI PEPPER CLASSIC**  
**Men's 70 AAA Division- 2 Teams**  
ALL GAMES @ El Paso County Sports Complex

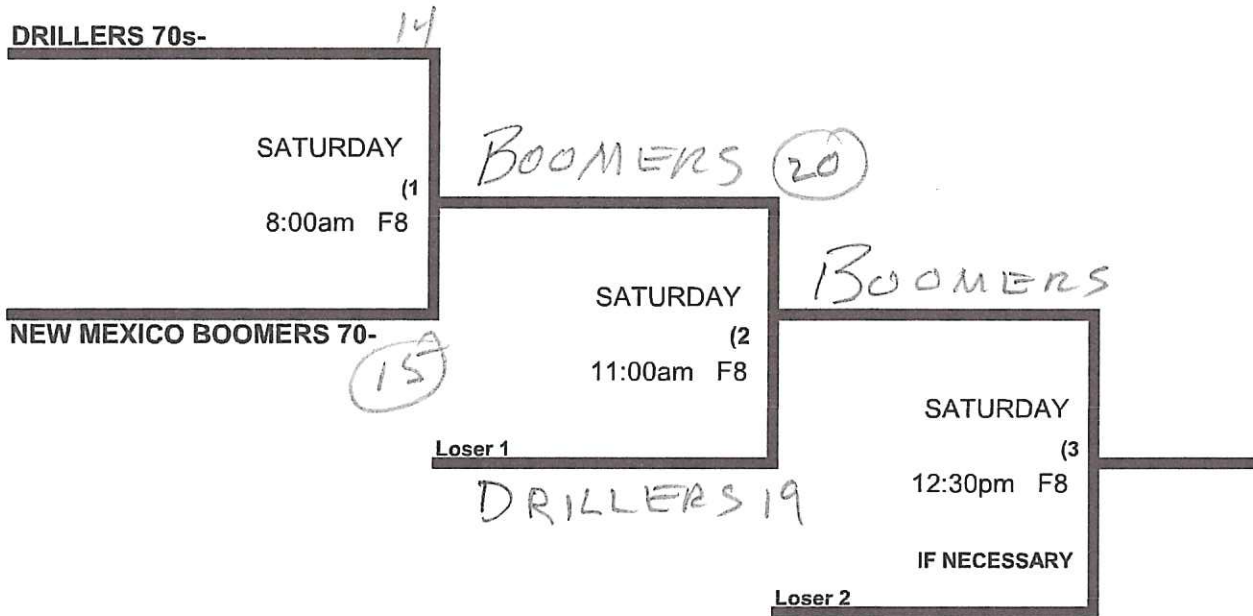

WINNER OF GAME 1 HAS THE OPTION OF HOME / VISITOR IN GAME #2